

morphy richards®

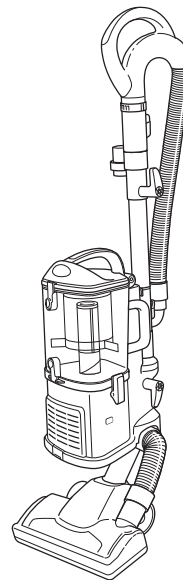

Register online for your 5 year guarantee. See back of this instruction book for details.
(UK and Ireland customers only)
www.morphyrichards.co.uk



Bagless Upright Vacuum Cleaner



Please read and keep these instructions

Getting the best from your new cleaner...

If your cleaner is not picking up as well as it should, please check

Dust canister

Empty the canister regularly, even if it does not appear full.

Filters

Clean the pre-motor filter at least every month or sooner, especially if used in dusty conditions. Clean the exhaust filter every six months.

Blockages

Check the hose, tubes and tools for blockages.



VC73410 MUK Rev 2

For competitions, product hints and tips and much more, join us online at our blog, Facebook or Twitter pages.



www.homeofthehouseproud.com



www.facebook.com/LoveYourHome



www.twitter.com/MRLoveYourHome

If you have a problem or complaint, please call our dedicated UK based helpline before returning your product to the retailer from where it was purchased.



UK Helpline: 0844 871 0960

Replacement Parts: 0844 873 0726

Ireland Helpline: 1800 409 119



For details of other Morphy Richards products, plus replacement parts and accessories, please see our website:

www.morphyrichards.com



CONTENTS

FEATURES	4
DUAL FUNCTIONALITY	5
UPRIGHT VACUUMING	5-6
LIFT AWAY CANISTER MODE	6-7
ADJUSTING SUCTION POWER	7
SAFETY CUT-OUTS	7
MAINTENANCE	8-10
STORAGE	10
HELPLINE & WEBSITE	10
IMPORTANT SAFETY INSTRUCTIONS	11
ELECTRICAL REQUIREMENTS	11
GUARANTEE	12

FEATURES

- 1 Handle
- 2 Stretch hose
- 3 Suction adjustment collar
- 4 Handle release button
- 5 Accessory holder
- 6 Upper cord wrap (quick release)
- 7 Cord hook
- 8 Extension tube
- 9 Extension tube release button
- 10 Carry handle
- 11 On/Off 3-position switch
- 12 Upper bin emptying release button
- 13 Dust canister
- 14 Screen filter
- 15 Lower bin emptying release button
- 16 Dust canister release latches
- 17 Lower cord wrap
- 18 Motor base
- 19 Lift Away canister release button
- 20 Exhaust filter
- 21 Floor brush nozzle tube
- 22 Floor brush nozzle hose
- 23 Motorised floor brush nozzle
- 24 Motorised floor brush indicator light
- 25 Rotating brush bar
- 26 Extra long crevice tool (model specific)
- 27 Crevice tool (model specific)
- 28 Dusting brush
- 29 Turbo nozzle (certain models only)
- 30 Lift Away canister

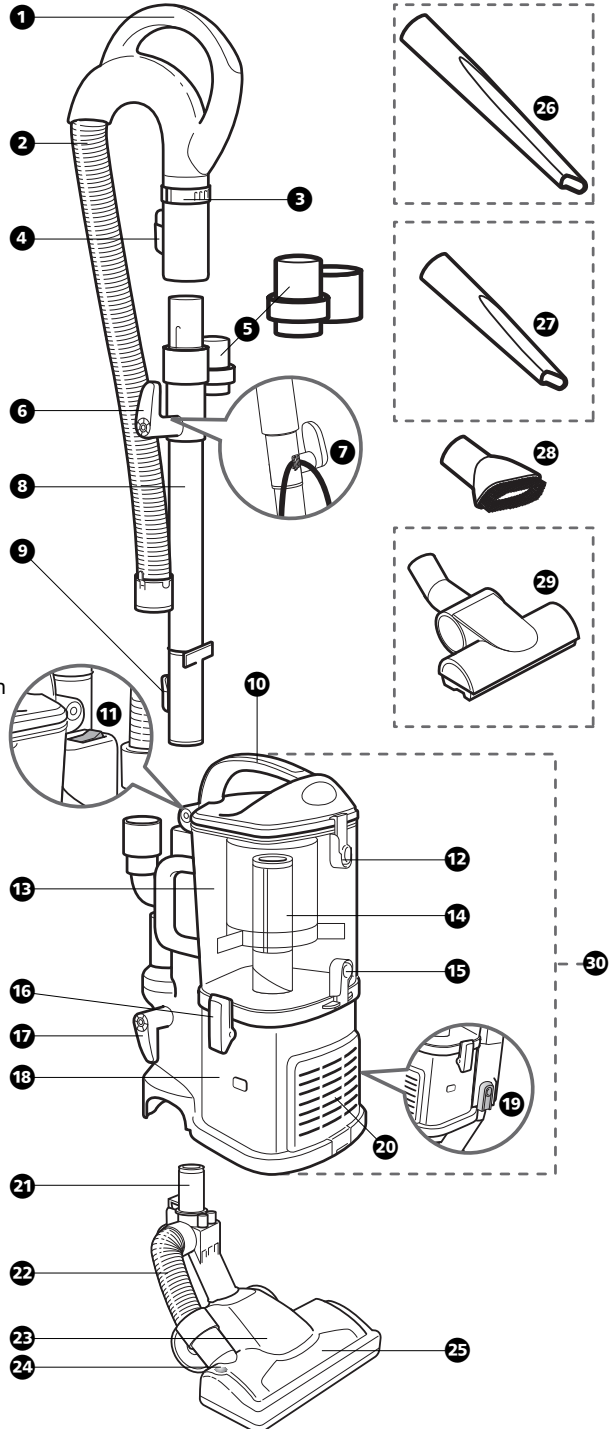

DUAL FUNCTIONALITY

Your vacuum cleaner can easily be configured into two different cleaning modes:

- Upright vacuum **A** for floors and carpets.
- Lift Away canister **B** which can be carried with you whilst cleaning hard to reach places.

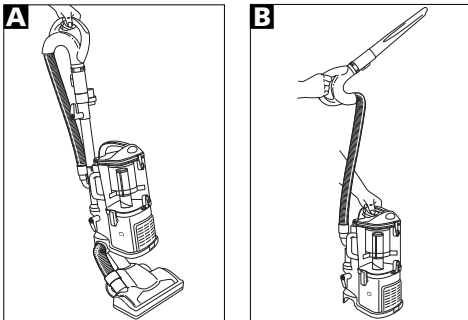

You can carry your vacuum cleaner in both modes by the carry handle **10** located on top of the dust canister **13**.

UPRIGHT VACUUMING

Assembly

- 1 Place the motorised floor brush nozzle **23** on a level surface and align the floor brush nozzle tube **24** with the tube on the Lift Away canister **30** and lower until you hear the two pieces click into place **C1**.

NOTE: The motorised floor brush nozzle must be fully locked in place to ensure the electrical connection is made.

- 2 Attach the end of the extension tube **8** to the tube on the back of the Lift Away canister **30** until it clicks in to place **C2**.
- 3 Slide the accessory holder **5** in to position opposite the upper cord wrap, over the extension tube **8**. Align the tab and groove and push down **C3**.

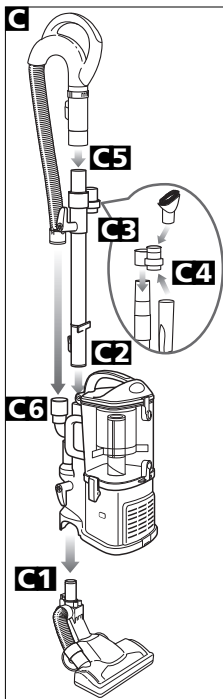

- 4 Store the dusting brush **26** and the crevice tool **26/27** on the mounts of the accessory holder **C4**.
- 5 Push the handle **1** onto the top of the extension tube **8** until you hear it click into place **C5**.
- 6 Insert the end of the stretch hose **2** into the connector on the back of the Lift Away canister **C6**.

Using in upright mode

- 1 Rotate the upper cord wrap **6** to quickly release the power cord.
- 2 Secure the power cord in the cord hook **7** **D**.

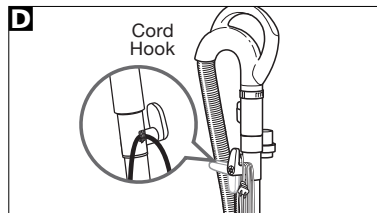

- 3 Press the On/Off 3-position switch **11** to the "I" position to vacuum hard floors (suction only) or to the "II" position to engage the motorised floor brush nozzle **23** (for vacuuming carpets and rugs) **E**.



- 4 NOTE: The rotating brush bar **25** on the motorised floor brush nozzle **23** will not spin unless the nozzle is flat against the floor and the handle **1** is tilted back.

Gently press the motorised floor brush nozzle **23** down with your foot while you grasp the handle **1** and tilt it back towards you **F**.

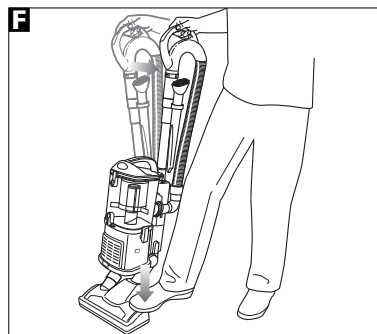

- **IMPORTANT:** The motorised floor brush indicator light **23 G** will illuminate green when the motorised floor brush is on, or red if there is a blockage or a jam (see 'Safety Cut-Outs' section on page 7).

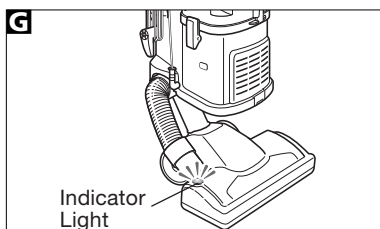

LIFT AWAY CANISTER MODE

This function is ideal for cleaning stairs, curtains, upholstery and hard to reach places.

Separate the Lift Away canister **30** from the motorised floor brush nozzle **23** by pressing the Lift Away canister release button **19 H1** on the side of the Lift Away canister, then gently hold the motorised floor brush nozzle to the floor with your foot **H2** and pull the Lift Away canister up.

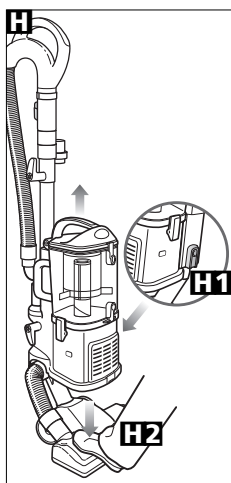

Using the attachments in Lift Away canister mode

Press the handle release button **4 I1** and pull the handle **1** up so the attachments can be used on the handle, or press the extension tube release button **9 I2** and pull the extension tube **8** up so the attachments can be used on the extension tube.

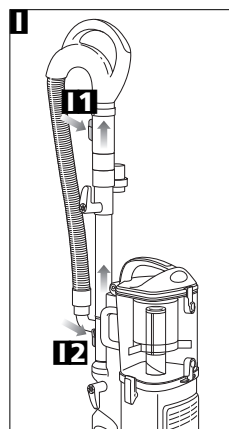

NOTE: Attachments should only be used in Lift Away canister mode, not in upright mode.

List of Attachments

Dusting brush 23 for delicate surfaces.

Crevice tool (26 or 27), depending on model) for awkward places, corners and behind radiators etc. This tool is also useful on stairs.

Turbo nozzle 29 (certain models only) is ideal for human and pet hair removal from stairs and upholstery.

- 1 Attach the desired accessory onto the end of either the extension tube **8** or the handle **1 I**.

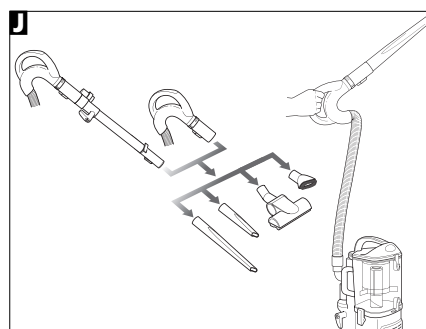

- 2 Press the On/Off 3-position switch **11** to the "I" position to turn the vacuum on for above-floor cleaning **E** and hold the handle **1** in one hand while you carry the Lift Away canister around the home with the other hand **E**.

Cleaning under furniture in Lift Away canister mode

This function is ideal for cleaning underneath low furniture.

- 1 Separate the Lift Away canister **30** from the motorised floor brush nozzle **23** by pressing the Lift Away canister release button **19** **H1** on the side of the Lift Away canister, then gently hold the motorised floor brush nozzle to the floor with your foot **I12** and pull the Lift Away canister up.
- 2 Press the extension tube release button **9** **I2** and pull the extension tube **8** up.
- 3 Attach the end of the extension tube **8** to the motorised floor brush nozzle **23** **K**.

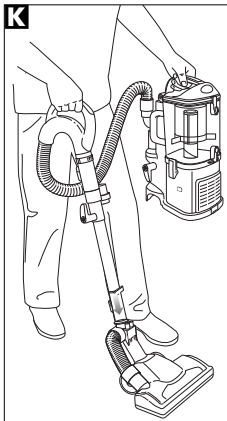

- 4 Press the On/Off 3-position switch **11** to the "I" position to turn the suction motor on **E**.

NOTE: The rotating brush bar **25 will not rotate in Lift Away canister mode.**

- 5 Tip the unit backwards to access under low furniture.

ADJUSTING SUCTION POWER

When using the attachments, the suction may be too powerful, adjust the suction power by rotating the suction adjustment collar **3** 90° anti-clockwise to open the valve to reduce suction **L**.

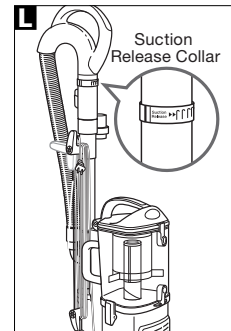

Rotate the collar clockwise to close the valve when you need high suction and for vacuuming floors.

SAFETY CUT-OUTS

If the cleaner overheats, a motor protection thermostat will automatically switch the motor off. If this happens, **switch the cleaner off, unplug from the power supply and leave the cleaner to cool for at least 90 minutes.** Check the airways for blockages, empty the dust canister and clean the filters before restarting.

If the rotating brush bar **25** becomes jammed, a safety cut-out will stop the brush and the indicator light **24** will change from green to red. If this happens, **switch off and unplug the product.** Disconnect the motorised floor brush nozzle and carefully remove the blockage.

MAINTENANCE

WARNING: Always unplug the vacuum cleaner from the mains supply before undertaking any of the following maintenance procedures.

Emptying the dust canister

Empty the dust canister **13** regularly even if it does not look full, this will maintain the performance.

- 1 Unplug the cleaner from the mains switch.
- 2 Undo the dust canister release latches **15** on each side of the Lift Away canister by lifting them up and outwards **M**.

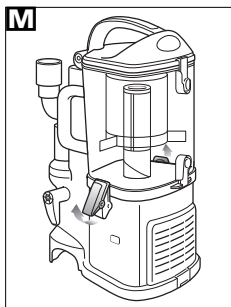

- 3 Remove the dust canister from the motor base **13**.
- 4 Hold the dust canister **13** over a bin and press the lower bin emptying release button **12** **N**. Tap gently to empty contents. Press the door shut again until it clicks into place.

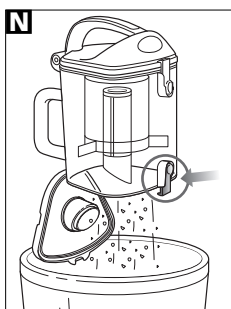

- 5 If required, turn the dust canister **13** upside down over the bin and press the upper bin emptying release button **12** **O**.

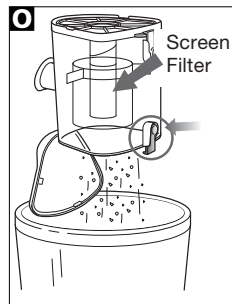

Tap gently to remove contents.

Use a dry cloth or paper towel to remove debris stuck to the screen filter **14** inside the dust canister **O**. Press the door shut again until it clicks into place.

Remember to periodically (at least once a month) clean the pre-motor filter (see below) before refitting the dust canister.

- 6 Replace the dust canister on top of the motor base **13**.
- 7 Hook the two dust canister release latches **15** onto the tabs on the sides of the dust canister **13** and push down to lock.

Pre-motor filter

(to be cleaned at least monthly)

- 1 Remove the dust canister **M**.
- 2 Pull the 2 filters out from the top of the motor base **13** **P**.

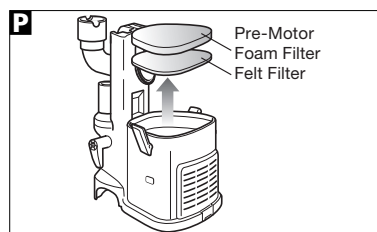

- 3 Rinse the filters thoroughly in lukewarm water until the water runs clear.

DO NOT put the filter in the washing machine or dishwasher.

NOTE: The material in the filter will discolour over time. This is normal and will not affect the performance of the filter.

- 4 Squeeze out excess water and allow to air-dry for at least 24 hours before replacing. Do not use a hair dryer or other heating methods to dry.
- 5 Replace the felt filter in first, then the foam filter.
- 6 Replace the dust canister.
- 6 Once the HEPA filter is dry, replace it back into the vacuum cleaner.
- 7 Replace the cover by inserting the two tabs into the holes at the top and then swinging the cover down until it clicks into place.

NOTE: The material in the filter will discolour over time. This is normal and will not affect the performance of the filter.

Exhaust filter

(to be cleaned at least every six months)

- 1 Remove the filter cover **Q**.

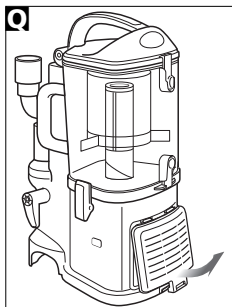

- 2 Take out the HEPA filter by pulling it straight out.
- 3 Turn the filter over so that the dirty side is on the bottom and vigorously tap it clean over a dustbin to remove any dust **R**.

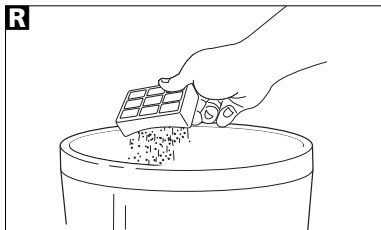

- 4 Wash the filter under the tap using lukewarm water with the dirty side face down until the water runs clear **S**.

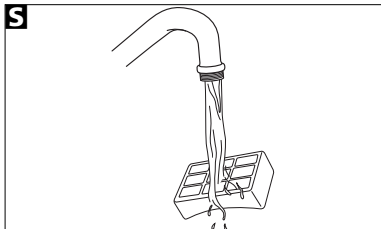

- 5 Allow the filter to air dry for 24 hours. Do not use a hair dryer or other heating methods to dry.

Hose blockages

The hoses **2** **22** may be detached and inspected by pulling out connections or squeezing the tabs together and pulling up where applicable **T**.

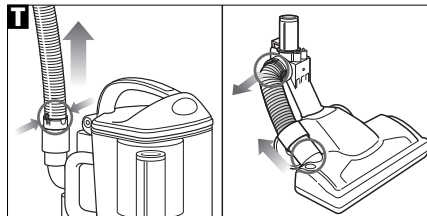

Straighten out the hoses and look inside for blockages. Also inspect inside the suction ducts on the vacuum cleaner.

Cleaning the motorised floor brush

- 1 Press the On/Off 3-position switch **1** to the "O" position to turn the vacuum off and unplug the power cord from the mains outlet.
- 2 Separate the Lift Away canister **30** from the motorised floor brush nozzle **23** by pressing the Lift Away canister release button **19** **H1** on the side of the Lift Away canister, then gently hold the motorised floor brush nozzle to the floor with your foot **H2** and pull the Lift Away canister up.
- 3 Turn the motorised floor brush over to inspect the rotating brush bar **25** and pull away any hairs or fibres. If they are tightly wound around the brush, carefully snip the fibres with scissors **U**, being careful not to damage the rotating brush bar, pull away from the rotating brush bar and dispose of.

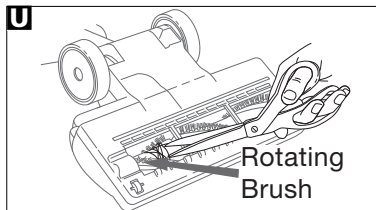

Cleaning the turbo nozzle

(certain models only)

The turbo nozzle **25** can be attached to either the handle **1** or the extension tube **8** as described in 'Using the attachments in Lift Away canister mode'.

Following use, your turbo nozzle may become clogged.

- 1 Press the On/Off 3-position switch **11** to the "O" position to turn the vacuum off and unplug the power cord from the mains outlet.
- 2 Remove the turbo nozzle from the extension tube **8** or handle **1**.
- 3 Slide the locking latch forward on the turbo nozzle and gently tilt the housing upward to open **V**.

IMPORTANT: DO NOT force; it will not open all the way.

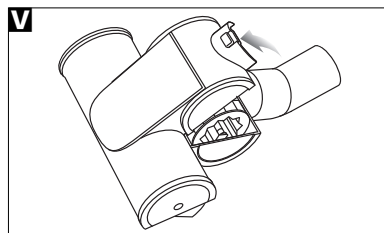

- 4 Carefully remove any blockage or debris.
- 5 Turn the turbo nozzle over to inspect the rotating brush bar and pull away any hairs or fibres. If they are tightly wound around the brush, carefully snip the fibres with scissors **W**, being careful not to damage the rotating brush bar, pull away from the rotating brush bar and dispose.

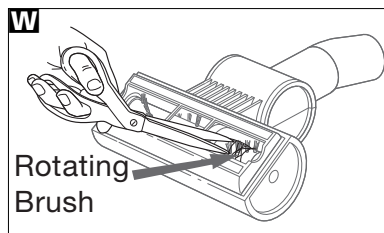

- 6 Push the housing back down and slide the locking latch backward to lock.

STORAGE

- 1 Convert your vacuum back to upright vacuum mode.
- 2 Rotate the upper cord wrap **6** to its upright position and coil the power cord loosely around the upper **6** and lower **17** cord wraps **X**.

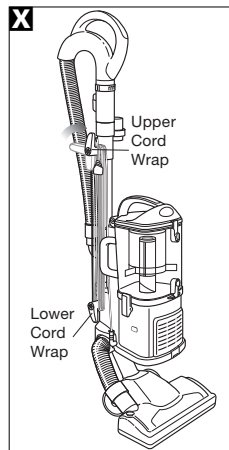

- 3 Store the dusting brush **23** and the crevice tool **25/27** on the mounts on the accessory holder **5**.

HELPLINE

If you have any difficulty with your appliance, do not hesitate to call us.

We are more likely to be able to help than the store from where you bought it.

Please have the following information ready to enable our staff to deal with your query quickly.

- Name of the product
- Model number as shown on the rear of the appliance.
- Serial number as shown on the rating label.

UK Helpline	0844 871 0960
Replacement Parts	0844 873 0726
Ireland Helpline	1800 409 119

WEBSITE

You may also contact us through our website, or visit the site to browse and purchase appliances, spare parts and accessories from the extensive Morphy Richards range.

www.morphyrichards.com

IMPORTANT SAFETY INSTRUCTIONS

The use of any electrical appliance requires the following common sense safety rules.

Please read these instructions carefully before using the product.

Primarily there is danger of injury or death and secondly the danger of damage to the appliance.

Personal safety

- Keep loose clothing, hair, fingers etc. away from the floor nozzle whenever the cleaner is connected to the mains.
- Only lift the product by the carry handle **10**.
- Disconnect from the mains supply before attempting to clear or clean the brush.
- Disconnect from the mains supply before cleaning or emptying the appliance.
- Never use in the presence of explosive liquid or vapours.
- Never pick up inflammable or poisonous liquids such as petrol, copier toner or other volatile substances. Never pick up acids, asbestos or asbestos dust.
- Never touch the plug, product or cable with wet hands.
- Unprofessional repairs can be dangerous for users.
- This appliance is not intended for use by persons (including children) with reduced physical, sensory or mental capabilities, or lack of experience and knowledge, unless they have been given supervision or instruction concerning use of the appliance by a person responsible for their safety.
- To protect against fire, electric shock and personal injury, do not immerse cord, plug or cleaner in water or other liquid.

Location

- Do not use or keep this product outside.
- Do not store the appliance near hot surfaces eg. ovens or heating appliances.

Mains lead

- Do not allow the mains lead to become strained or run this appliance over it.

- If the electrical cable becomes damaged, the cable assembly must be replaced. Do not attempt this task yourself, contact the helpline number that is found on page 10.

Product safety

- Never use the appliance without the filters being installed.
- Never use the appliance to vacuum hot ashes, broken glass, sharp objects or liquids.
- Never over-extend the hose such that the cleaner is pulled over. If the cleaner is knocked over, switch off before attempting to upright.
- Never pick the cleaner up by the floor nozzle when connected to the mains, use the carrying handle.
- Never modify the cleaner in any way.
- Use only Morphy Richards spare parts and accessories.
- The appliance must never be left running unsupervised.
- This appliance is intended for domestic use only. Misuse or use for commercial or any other purpose will render the guarantee invalid.
- Always disconnect the appliance from the mains supply after use.

Children

- Children do not understand the dangers associated with operating electrical appliances. Never allow children to use this appliance.
- Children should be supervised to ensure that they do not play with the appliance, or stumble over the power cord.

ELECTRICAL REQUIREMENTS

Check that the voltage on the rating plate of your appliance corresponds with your house electricity supply which must be A.C. (Alternating current).

If the socket outlets in your home are not suitable for the plug supplied with this appliance, the plug should be removed and the appropriate one fitted.

WARNING: The plug removed from the mains lead, if severed, must be destroyed, as a plug with a bared flexible cord is hazardous if engaged into a live socket outlet.

Should the fuse in the 13 amp plug require changing, a 13 amp BS1362 fuse must be fitted.

REGISTERING YOUR FIVE YEAR GUARANTEE

- Available on registration in the UK only.

Your standard 2 year guarantee is extended for an additional 3 years when you register the product within 28 days of purchase with Morphy Richards. If you do not register the product with Morphy Richards within 28 days, your product is guaranteed for 2 years. To validate your 5 year guarantee, register with us online at www.morphyrichards.co.uk.

N.B. Each qualifying product needs to be registered with Morphy Richards individually.

Please note that the 5 year guarantee is only available in the UK and Ireland. Please refer to the 2 year guarantee for more information.

YOUR TWO YEAR GUARANTEE

To qualify for the 2 year guarantee, the appliance must have been used according to the instructions supplied.

It is important to retain the retailer's receipt as proof of purchase. Staple your receipt to this back cover for future reference.

Please quote the following information if the product develops a fault. These numbers can be found on the base of the product.

Model number:

Serial number:

Morphy Richards products are intended for household use only.

Morphy Richards has a policy of continuous improvement in product quality and design. The company, therefore, reserves the right to change the specification of its models at any time.

All Morphy Richards products are individually tested before leaving the factory. In the unlikely event of any appliance proving to be faulty within 28 days of purchase, it may be returned to the place of purchase for it to be replaced. Alternatively, if you have a problem, don't take it back to the retailer, instead call our helpline: 0844 871 0960 (for products purchased within the UK only).

If the fault develops after 28 days and within 24 months of original purchase, you should contact the Morphy Richards Helpline number quoting the Model number and Serial number on the product, or write to Morphy Richards at the address shown on the back of this booklet. However, if you suspect a fault, follow the simple checks detailed below before retrying the appliance or calling the helpline.

- Check the filters.
- Check the tools / tubes for blockages.
- Check the plug is firmly in the socket.
- Check the socket is working by trying another appliance.
- Check the fuse in the plug.

Subject to the exclusions set out below, the faulty appliance will then be repaired or replaced and dispatched usually within 7 working days of receipt. You may be asked to provide a copy of the proof of purchase.

If, for any reason, this item is replaced during the 2 year guarantee period, the guarantee on the new item will be calculated from original purchase date. Therefore, it

is vital to retain your original till receipt or invoice to indicate the date of initial purchase.

EXCLUSIONS

Morphy Richards shall not be liable to replace or repair the goods under the terms of the guarantee where:

- 1 The fault has been caused or is attributable to accidental use, abnormal use, misuse, negligent use or used contrary to the manufacturer's recommendations or where the fault has been caused by power surges or damage caused in transit.
 - 2 The appliance has been used on a voltage supply other than that stamped on the products.
 - 3 Repairs have been attempted by persons other than our service staff (or authorised dealer).
 - 4 The appliance has been used for hire purposes or non domestic use.
 - 5 The appliance is second hand.
 - 6 Morphy Richards reserves the right not to carry out any type of servicing or repair work, under the guarantee, at its discretion.
 - 7 The guarantee excludes consumables such as filters.
- This guarantee does not confer any rights other than those expressly set out above and does not cover any claims for consequential loss or damage. This guarantee is offered as an additional benefit and does not affect your statutory rights as a consumer.

morphy richards

**The After Sales Division
Morphy Richards Ltd**
Mexborough, South Yorkshire,
England, S64 8AJ

Helplines (office hours)
UK 0844 871 0960
Spare Parts 0844 873 0726
Republic of Ireland 1800 409 119
VC73410MUK Rev2 03/11

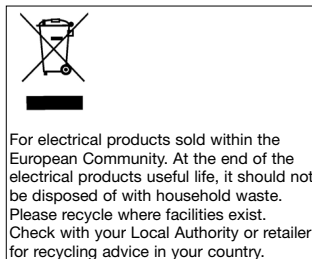

For details of other Morphy Richards products, plus replacement parts and accessories, please see our website:

www.morphyrichards.com